

Cod. D522501

White

DOP-No 997

Wall hung 4,5 L flush. To be completed with seat and cover. For assembly with suitable wall mounted chair brackets and acoustic insulation set.

IMMAGINE
NON DISPONIBILE

Width (mm)	360
Depth (mm)	530
Height (mm)	350
Weight (Kg)	18,1
Flush Volume (l)	4,5
Installation	wall hung
Outlet	horizontal outlet

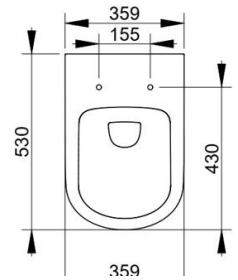
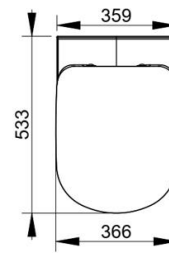
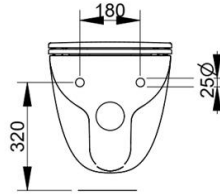
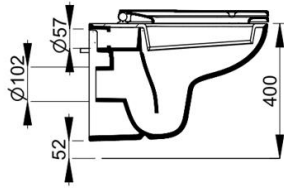
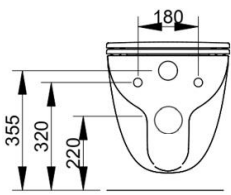

SEAT and COVER (NOT INCLUDE)



S523201

Normal closing seat and cover.



S523301

Soft closing seat and cover.

NOT PROVIDED FIXINGS / ACCESSORIES / SPARE PARTS

(* Mandatory)



F953499

Spare kit for F950399 chair brackets: screw, washer, cover.



F953099

Chair brackets for wall hung wc/bidet.



F953999

Protection set for acoustic insulation for WH installation.



VS52701

Buffers kit for Mia/Mirto/Gemma2 seat and cover



VS52101

Hinges for Gemma2 normal closing seat and cover



VS52301

Hinges for Gemma2 soft
closing seat and cover